



Throughout history, borders have been extensively defined and have established radical realms between communities and urban/natural environments. These borders, manifested mentally and physically, have feed up struggled perspectives toward continuity of urban fabric and challenge the motion of a vision where different peoples may coexist with one another with the absence of physical barriers.

The notion of the “Peace Walls” has offered a possible secured stability for violent conflicts and presented somewhat security for the residents of Belfast, Ireland. However, a question remains. Does humanity need superimposed architectural expressions to feel secure? Will they ever be humanized? most importantly, are they capable to bring happiness to an entire neighborhood?

In fact, what makes a neighborhood a neighborhood? And in this case, what would make this new candidate site a productive zone? Perhaps Neighbors! Connections and so much more to imagine and concise together!

**OUTgrow** Zone envisions a present and a future, where it challenges the notion of edges superimposed by architectural expressions that have been embedded (and intend to be reinvented by the proposal of Greenway) into the site’s context by integrating public housing and public street realm together.

Instead of imagining a separate zone, **OUTgrow** intends to invite old and new residents of the area to share and perform activities together through the implementation of active and flexible structures that host multiple recreational programs. These programs will help **OUTgrow**’s Zone residents to self-sustain economically and encourage exposure to their talents and culture.

To accomplish this intention, **OUTgrow** Zone utilizes a simple, flexible yet dynamic design modular pattern that serves to define the location of these multiple structures let the people itself to define the programs that are needed to encourage re-integration of different communities and call out for public housing recruitment lotteries/distribution.

For the public housing realm, the proportion of the pattern allow for accommodation of modular 2-story houses, constructed by low-impact materials like CLT (cross-laminated timber) panels and beams. A typical modular house also incorporates a water tank for rain collection, recycling program and a shared garden for a healthier lifestyle.

The proposed dynamic pattern will also help to integrate residential circulation with the amenities, and reincorporate back to public circulation (derived from the Greenway Belt)

# OUTGROW

ZONE  
VISION PLAN

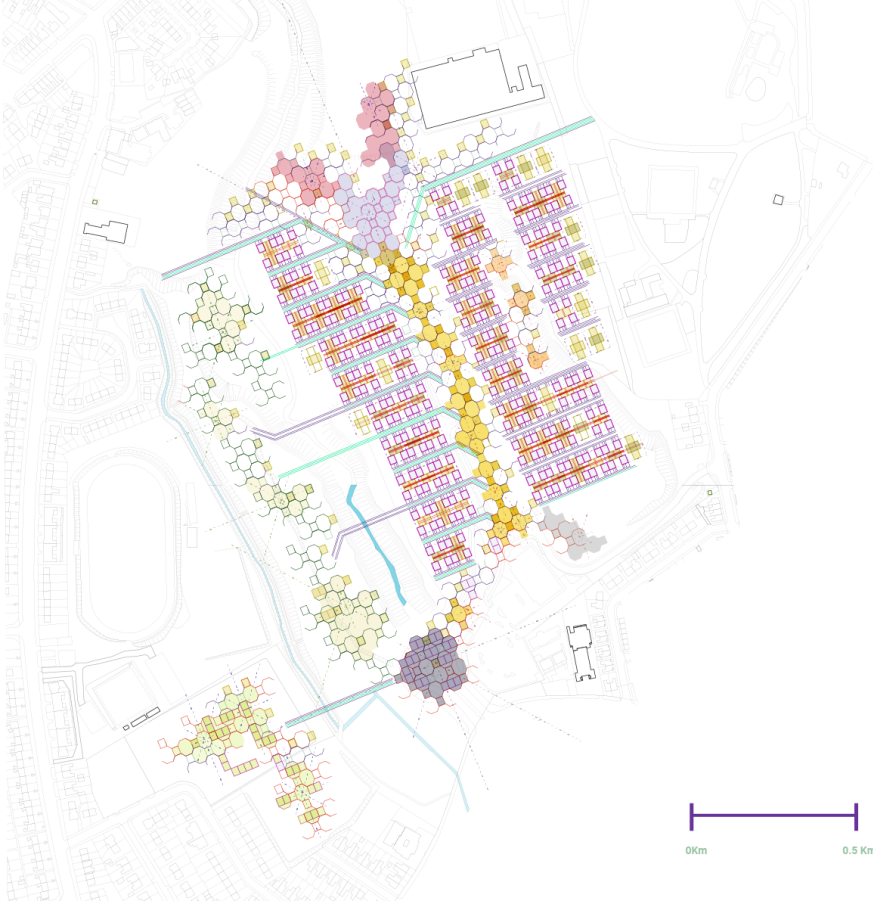



### OUTGROW GRID PATTERN

Based on the 6.240 x 7.620-meter module

(Defines housing units, recreational structures and paths)



### OUTGROW'S NODES

Location of crucial programs and definition of circulation/path direction.



### BIOSWHALE/WETLAND PARKS

For residents and all



### RAINWATER HARVEST/HYDROPHONIC COMMUNITY FARMS

By residents and all, for residents and all

(Structures that accommodate hydroponic farms to reinforce local residents and OUTGROW residents interactions)



### OUTGROW BAZAAR MARKET

By residents, for residents and all

(Structures that accommodate a Grand market that supports OUTGROW residents economic needs and promotes their abilities/talents)



### OUTGROW DISCHARGE STATION

For residents and all.

(Area for transportation market discharge/residential parking)



### OUTGROW AMENITIES CORE

For residents

(Accommodate structures for community recreation + support services such as meeting rooms, nurseries, classrooms, large studios/spaces for residents to define their purpose. and residential amenities such as laundromats/other)



### OUTGROW HOUSING UNIT PAIRS

For residents in need (Homeless + Refugees)

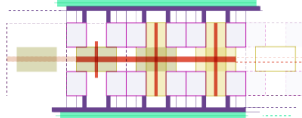

### LEGEND

- Unit
- Lot
- Shared Garden
- Residential Circulation
- Outdoor Pedestrian Circulation
- Residential Active Circulation (connects to GreenWay bike path)

### GROUP PAIRS:

Co-Living (for the young) - ADA Individuals (for the elderly/individuals with special needs)  
1-3 Bed units (for families) - Studios (for individuals/pairs)



### OUTGROW PLAYGROUNDS

For residents' children

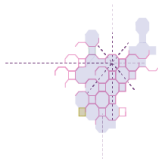

### OUTGROW PLAZA

By residents, for residents and all

(Outdoor spaces for recreational activities and social recruitments for housing residency)



### OUTGROW COMMUNITY/SERVE CENTERS

By professional for residents and all.

(Centers that support connection between the neighborhood's residents and OUTGROW residents)

# OUTGROW

ZONE  
CIRCULATION PLAN

## LEGEND

- Neighbor Pedestrian Path
- OUTGROW Pedestrian Path
- Neighboring Bike Path (Greenway)
- OUTGROW Resident Bike Path



# IN OUTGROW, THE PEOPLE DESIGN AND BUILD AS THEY LIVE

## AUTONOMY

### HEALTHY SPACES

"Let's take a walk!"



"How can we help you?"

### ADAPTING CHALLENGES

"We are harvesting the rain for our hydroponic farms. How cool is that!"

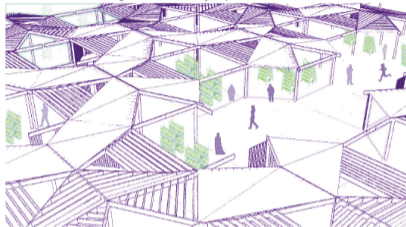

### INCLUSIVE RELATIONSHIPS + HEALTHY SPACES

"Hello Neighbor. Welcome!"



### CO-CREATION

"Here I got my own stall to sell my craft"

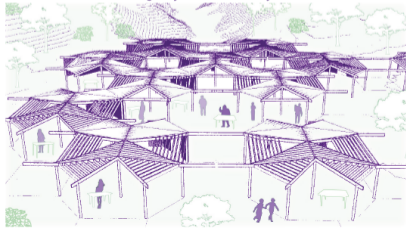

Walls and fences are continuously being imposed among all of us.  
They are visible in many forms. Physically and mentally.



But people have started to wonder:  
**WHAT IF...**

What if we invite people to filter in?  
What if we outgrow together from this established barrier that keeps us dividing among our families and selves?



By following the simple idea of gathering together to do something together?  
Like shopping together, gardening together, play together...and so much more **TOGETHER**

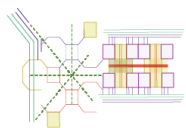
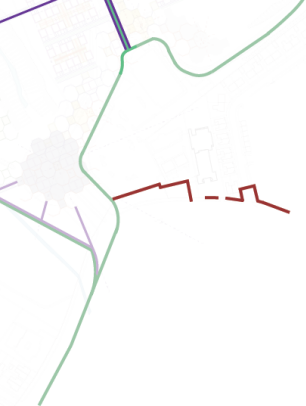

# OUTGROW

ZONE  
RESIDENTIAL STREET REALM



# OUTGROW

ZONE  
RESIDENTIAL STREET REALM-AMENITIES





# OUTGROW

ZONE  
TYPICAL DWELLING



# OUTGROW

ZONE

TYPICAL DWELLING-COLIVING



**OUTGROW**  
ZONE  
DRAWING HOPE

